



Winstone Wallboards Ltd



Tropex Exports
Product Training

About Winstone Wallboards

- Ø NZ's largest manufacturer and marketer of gypsum plasterboard, drywall systems, associated products and services
- Ø Operating since 1927 and manufactures plasterboard systems under the GIB® brand name
- Ø Facilities in Auckland, Wellington and Christchurch
- Ø Part of the Building Products Division of Fletcher Building



The GIB® brand is a NZ icon brand and Winstone Wallboards has a proud heritage of being a NZ focused and NZ based company.

GIB® Plasterboard: More than 80 years in the making

The production of GIB® plasterboard has evolved remarkably through the years.



In the beginning...

1920's – mixing entirely by hand

1930's - drying time for some products were 24hrs.

1950's - plasterboard loaded onto crates for transport by ship.

Today, the mechanism and automation of manufacturing are instrumental to the success of the GIB® brand.

*Follow the evolution of GIB® plasterboard production & distribution through the years. View or download the **80th year Celebration article** at www.gib.co.nz*



Plasterboard



GIB® Plasterboard

We offer a range of plasterboard options for different residential and commercial jobs.

GIB® products and systems are:

- Ø manufactured in NZ for NZ conditions
- Ø thoroughly tested to ensure all performance requirements are met
- Ø BRANZ appraised,

so you can **specify and install with confidence.**

GIB® Plasterboard

GIB® Standard

- Ø Economical, available in 10mm and 13mm thicknesses.
- Ø 13mm GIB® Standard plasterboard recommended for ceilings.

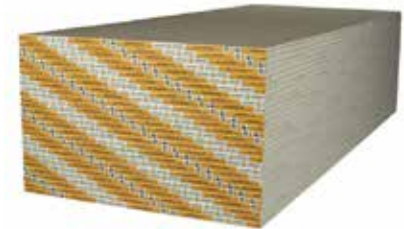

GIB Wideline®

- Ø 1350mm wide, so ideal for horizontal fixing on 2.7m studs.
- Ø Results in fewer joints and a better finish.



GIB Ultraline® & GIB Ultraline® PLUS

- Ø Stronger and more rigid.
- Ø Pearlcoat coated paper technology with a smoother finer texture helps provide a superior finish.



GIB® Plasterboard

GIB Toughline®

- Ø Woven fibreglass gives added resistance to impact damage and reduces repair costs.
- Ø Ideal for high traffic areas e.g. stairwells, halls, garages, hospitals, schools, kid's bedrooms.



Dual Purpose GIB Braceline® & GIB Noiseline®

- Ø GIB Braceline® with GIB Ezy Brace® System for walls that need additional bracing.
- Ø GIB Noiseline® in a GIB Noise Control® System to reduce noise transmission between rooms and floors in two storey homes.
- Ø Stronger and more rigid than standard GIB® plasterboard.
- Ø High density core for extra bracing and noise control.

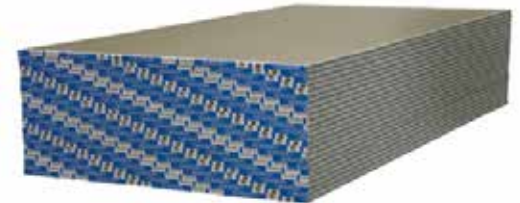

GIB® Plasterboard

GIB Aqualine®

- Ø Special water resistant core to help prevent moisture damage.
- Ø Use on walls and ceilings in bathrooms, kitchens and laundries.
- Ø Ideal substrate for paint, wallpaper, tiles and shower liners.

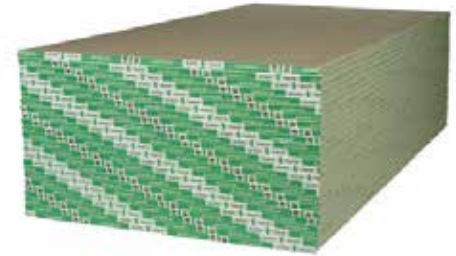

GIB Fyreline®

- Ø High density, modified core which resists exposure to fire longer than standard plasterboard
- Ø Provides systems with up to four hours fire protection.
- Ø Use in areas where extra fire protection is needed.



GIB X-Block®

GIB X-Block® is formulated to provide x-ray shielding in hospitals and medical centres.



Other Plasterboard Products

GIB Toughrock® Aqua

- Ø Ultra strong, made from 95% recycled gypsum fibre.
- Ø For areas needing superior strength, dent and impact resistance.
- Ø Suitable for wet areas.
- Ø Sheet size per m² - 1200 x 3000mm

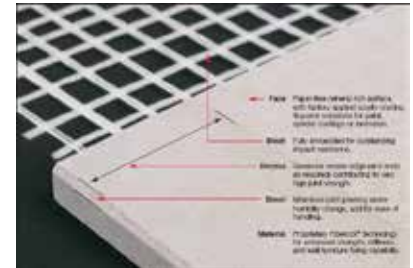

GIB Sound Barrier® timber

- Ø Reduces airborne and impact sound transmission through timber floors.
- Ø High density compressed gypsum fibreboard sheet material
- Ø Suitable for overlaying with ceramic tiles, timber strip flooring, carpet or vinyl floor coverings.
- Ø Sheet size per m² - 1200 x 2700mm



GIB-Tone® Tiles

- Ø Suspended ceiling tiles.
- Ø Available in white vinyl/powder coated or GIB® Standard plasterboard paper.
- Ø 1195 x 595mm, in 10 or 13mm thickness.





The GIB® Plasterboard Selector Chart

	GIB® Standard plasterboard		GIB Wideline®		GIB Ultraline®	GIB Ultraline® PLUS		GIB Toughline®	GIB Braceline® & GIB Noiseline®			GIB Aqualine®		GIB Fyreline®		
Thickness (mm)	10	13	10	13	10	13	13	13	10	10	13	10	13	10	13	16
Width (mm)	1200	1200	1350	1350	1200	1200	1350	1200	1200	1350	1200	1200	1200	1200	1200	1200
LENGTH	2400mm	★														
	2700mm															
	3000mm	★														
	3300mm															
	3600mm	★		★												
	4200mm	★														
	4800mm	★		★	★			★		★	★		★			
	6000mm	★		★												

*GIB Patch Board is available in 10mm thickness, GIB® Standard plasterboard 590 mm x 1200mm

Tapered Edge/Tapered Edge
 ★ Square Edge/Tapered Edge

- A free cut-to-length service is available on orders over 100 sheets. Contact your local building merchant
- GIB® Plasterboard can be delivered in house lots the next day to site in the greater Auckland region, Wellington, Christchurch or your local building merchant

For more information call the GIB® Helpline 0800 100 442 or visit www.gib.co.nz

Board Substitution

With the wide range of plasterboard types there are some overlaps in functionality. A tick indicates that the board can perform the same function as that of the original board.

		GIB® Standard	GIB Fyreline®	GIB Braceline® GIB Noiseline®	GIB Aqualine®	GIB Ultraline®	GIB Toughline®
Original Specified Board 10mm		10	10	10	10	10	
GIB® Standard	10		ü	ü	ü	ü	
GIB Fyreline®	10			ü	ü	ü	
GIB Braceline® GIB Noiseline®	10				Notes 2/3		
GIB Aqualine®	10						
GIB Ultraline®	10						
Original Specified Board 13mm		13	13	13	13	13	13
GIB® Standard	13		ü	ü	ü	ü	ü
GIB Fyreline®	13			ü	ü		ü
GIB Braceline® GIB Noiseline®	13		Notes 1/3		Notes 2/3		Note 3
GIB Aqualine®	13						
GIB Ultraline®	13						
GIB Toughline®	13						

NOTE 1 Fastener type and length must be as specified for the relevant fire system at 100mm centres to the perimeter of the element. Bracing element must be 900mm or greater. Corner fastening pattern applies.

NOTE 2 GIB Braceline® nails or screws at 100mm centres to the perimeter of the element. The bracing element must be 900mm or greater. Corner fastening pattern and hold downs apply.

NOTE 3 Bracing function can be met but noise control will be reduced

Ordering Calculation Guides

Plasterboard sheets			Adhesives Usage Rates		
Sheet width	Sheet length	Sheet area m ²	375ml cartridge	17m ² of plasterboard	
			600ml sausage	28m ² of plasterboard	
1200	2400	2.88	4 litre pail	170m ² of plasterboard	
1200	2700	3.24	GIB Soundseal[®] Usage Rates		
1200	3000	3.60	Bead size	375ml Cartridge	600ml sausage
1200	3300	3.96	10mm x 10mm	3.75 lineal metres	6.0 lineal meters
1200	3600	4.32	10mm x 5mm	7.5 lineal metres	12.0 lineal meters
1200	4200	5.04	Fastenings Usage Rates		
1200	4800	5.76	Screws	Approx. 800 per 100m ² plasterboard	
1200	6000	7.20	Nails	Approx. 5kg per 100m ² plasterboard	
1350	3600	4.86	As the amount of fastenings and adhesives can vary greatly depending on framing spacings etc. these figures are intended only as a guide.		
1350	4800	6.48			
1350	6000	8.10			

Compounds





Winstone Wallboards has a comprehensive range of GIB® compounds to joint GIB® plasterboard sheets and create a smooth finish ready for decorating.

Selecting the right compound is easy.

Ezi-View Compound Selector

GIB® COMPOUND SELECTOR CHART



	GIB Tradaset®	GIB MaxSet®	GIB X-Block®	GIB Lite Blue®	GIB ProMix® Lite	
Suitable for Joint coat	Bascoat	✓	✓	✗	✗	
	2nd Coat	✓	✓	✓	✗	
	Finishing Coat	✗	✗	✗	✗	✓
	Suitable for Cove	✗	✗	✗	✗	✗
Compound Type	Setting	Setting	Air Drying Powder	Setting	Air Drying Ready Mix	
Sanding	Moderate	Hard	Moderate	Easy	Easy	
Working/Set Times (mins)	20, 45, 90 & 150	90	-	90	-	
Product Size	5 kg*, 20 kg	20 kg	20 kg	17.5 kg	15 L & 14 L Carton	
Main Benefits	<ul style="list-style-type: none"> Ideal for bedding tape Machine tool compatible Variety of setting times available 	<ul style="list-style-type: none"> Mechanically strong Strong tape adhesion even in higher temperatures Sets hard for faster jointing Maximum coverage with low shrinkage 	<ul style="list-style-type: none"> Formulated to reduce x-ray transmissions High shrinkage to create a denser joint No need to back joints with lead strips 	<ul style="list-style-type: none"> Easy to sand Machine and hand tool application Low shrinkage 	<ul style="list-style-type: none"> Easy to sand by hand Light weight and smooth to trowel Yellow tint enables easy top coat identification when sanding Low shrinkage 	

*GIB Tradaset® 150 is only available in 20 kg bags.

** For Victor® MultiPlus, refer to Solid rendering on page 22.



	GIB® Trade Finish™	GIB® U-Mix	GIB Plus-4®	GIB ProMix® All Purpose	GIB Cove® Bond	Victor® Cornice Bond
	✗	✗	✓	✓	✗	✗
	✗	✗	✓	✓	✗	✗
	✓	✓	✓	✓	✗	✗
	✗	✗	✗	✗	✓	✓
	Air Drying Ready Mix	Air Drying Powder	Air Drying Ready Mix	Air Drying Ready Mix	Setting	Setting
	Moderate	Easy	Easy	Easy	Hard	Hard
	-	-	-	-	45 & 90	30
	15 L & 14 L Carton	20 kg	4 L, 10 L, 15 L & 14 L Carton	4 L, 10 L, 15 L & 14 L Carton	5 kg & 20 kg	20 kg
	<ul style="list-style-type: none"> Low shrinkage and easier to achieve a smooth finish Super slick and easy on wrists if applied by trowel Suitable for use with mechanical finishing tools Suitable for both hand and machine sanding 	<ul style="list-style-type: none"> Economical finishing compound Adjust viscosity as required on site Good open time Machine tool compatible 	<ul style="list-style-type: none"> Suitable for all three jointing coats Ideal for skim coating Excellent adhesion to a variety of substrates 	<ul style="list-style-type: none"> Suitable for all three jointing coats Heavy weight makes it ideal for filling or covering uneven surfaces Machine application and sanding 	<ul style="list-style-type: none"> Excellent "wet tack" Suitable for back blocking Two setting times available 	<ul style="list-style-type: none"> Specifically designed for adhering fibrous plaster products Excellent adhesion and great for renovation work

Basecoat Compounds

GIB Tradeset®

- Ø Machine and hand tool application
- Ø 20, 45, 90, 150 setting times available
- Ø Ideal for bedding in tape
- Ø Great for small jobs or patching holes



GIB MaxSet®

- Ø Strong tape adhesion even in high temperatures
- Ø Sets hard for faster jointing
- Ø Maximum coverage with low shrinkage



GIB X-Block®

- Ø Formulated to reduce x-ray transmissions
- Ø High shrinkage to create a denser joint
- Ø No need to back joints with lead strips



GIB Lite Blue®

- Ø Easy to sand
- Ø Machine and hand tool application
- Ø Low shrinkage



Finishing or Topping Compounds

GIB ProMix® Lite

- Ø Easy to sand by hand
- Ø Yellow tint enables easy top coat identification when sanding
- Ø Low shrinkage
- Ø Also available in 14 litre refill cartons
- Ø The cartons are recyclable and reduce on-site waste by eliminating an extra plastic pail with lid



GIB® Trade Finish™

- Ø Ready-Mix heavy weight Air Drying jointing compound
- Ø Suitable as a finishing coat
- Ø Can be applied by hand trowel or mechanical finishing tool
- Ø Suitable for machine sanding
- Ø Super slick and easy on wrists if applied by trowel
- Ø Low shrinkage and easier to achieve a smooth finish
- Ø Available in 22.2kg cartons (14L) and 23.8kg pail (15L)



GIB® U-Mix Finishing Compound

(formerly GIB® All Purpose Jointing Compound)

- Ø Economical finishing compound
- Ø Adjust viscosity as required on site
- Ø Good open time, machine tool compatible



Multipurpose Air Drying Compounds

GIB Plus 4®

- Ø Suitable for all three jointing coats
- Ø Ideal for skim coating
- Ø Excellent adhesion to a variety of substrates.
- Ø Now also available in 14 litre refill cartons.
- Ø The cartons are recyclable and reduce on-site waste by eliminating an extra plastic pail with lid.



GIB ProMix® All Purpose

- Ø Suitable for all three jointing coats
- Ø Heavy weight makes it ideal for filling or covering uneven surfaces
- Ø Machine application and sanding
- Ø Also available in 14 litre refill cartons.
- Ø The cartons are recyclable and reduce on-site waste by eliminating an extra plastic pail with lid.



Cove and Cornice Compounds

GIB-Cove® Bond

- Ø Excellent “wet tack”
- Ø Suitable for back blocking
- Ø Available in 45 and 90 set times



Victor® Cornice Bond

- Ø Great spreadability
- Ø Excellent adhesion
- Ø Ideal for skim coating



Approximate coverage of Joint Compounds

	Coverage in linear metres per kg		Coverage in linear metres per package size
	2 coats (taping plus 1 coat)		
GIB Tradeset®	10		200 (per 20 kg bag)
GIB Lite Blue®	11		187 (per 17.5 kg bag)
GIB MaxSet®	13		256 (per 20 kg bag)
	Top coat only		
GIB ProMix® Lite	9		172 (per 19 kg pail)
GIB® U-Mix Finishing Compound	19		371 (per 20 kg bag)
GIB® Top Coat	8		189 (per 24 kg pail)
	All 3 coats (taping plus 2 coats)	Top coat only	
GIB ProMix® All Purpose	3	8	69 (per 22.5 kg pail)
GIB Plus 4® ***	5	10	146 (per 15 kg pail)

*** Skim coat coverage at 1 mm thick is approx. 10 m² per kg or 20 m² at 0.5 mm thick

Note, these are estimated quantities only and can vary significantly due to site conditions and fixing practices. They are intended as a rough guide only and should not be used for quoting purposes.

Hot weather conditions (drying out before setting)

To avoid drying out before setting, Winstone Wallboards recommends:

- ∅ Do not use 150 minute set time compounds when the temperature exceeds 25-30°C (in front or behind the joint, e.g. skillion roof on a hot day can create very high temperatures behind a joint)
- ∅ Plaster ceiling joints located directly under roofs in early morning when temperature is cooler
- ∅ Be wary where no ceiling insulation exists e.g. garages, as the plasterboard can be hotter causing compound to dry quickly
- ∅ Use back-blocking to significantly reduce the amount of load transferred to the joint

Drying out before setting can occur due to a number of reasons, including:

- ∅ high temperature, high airflow, low humidity
- ∅ longer set time compounds
- ∅ inadequate compound placed under the tape or no compound placed over the tape immediately after bedding in of tape
- ∅ compound is watered down or unauthorised retardants are added

General limitations and recommendations

- Ø Ensure that (partially) hardened compound is not mixed with fresh compound
- Ø Ensure tools are thoroughly cleaned when using a new batch of compound
- Ø GIB® compounds are for interior use only and should not be exposed to high levels of moisture
- Ø Generally a longer set time compound has a marginally lower joint strength
- Ø Adhesion in setting compounds is by mechanical entanglement with the surface of the board.
- Ø Do not apply setting compounds over air drying materials
- Ø Do not use setting compounds for skim coating walls, as a thin coating will dry out before setting and can cause issues with paint adhesion
- Ø Air drying compounds are normally not suitable for gaps larger than 4 mm or holes deeper than 1 mm, as they take an excessive amount of time to dry out. A setting compound should be used in this situation.

Drywall Accessories



The GIB-Cove® Range

- ∅ Options available to suit your customer's personal style.
- ∅ Use at ceiling-to-wall junction for an attractive curved or stepped look.
- ∅ Reduces the likelihood of cracks appearing.
- ∅ No special tools or fixing equipment required, so simple to install.

GIB-Cove® Profiles

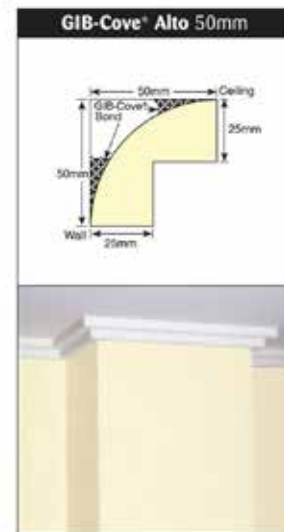
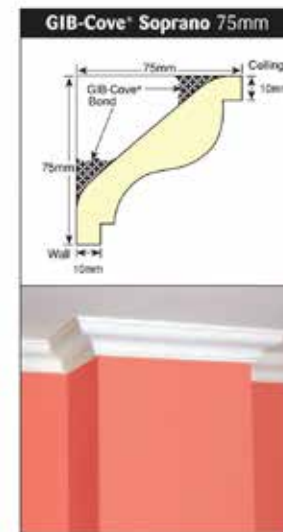
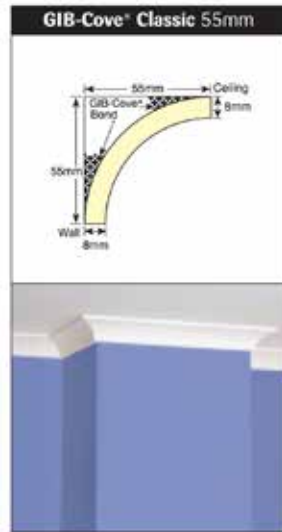
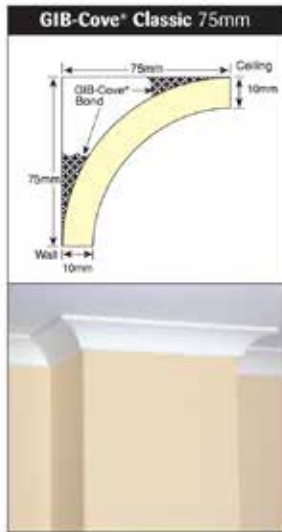
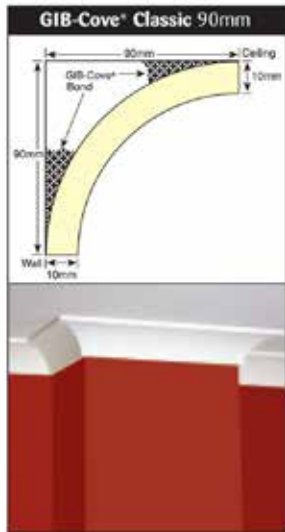

Fasteners



GIB® Grabber™ - High Thread (for fixing to timber)

- Ø Scavenger Head Drywall High Thread for fixing GIB® plasterboard to timber.
- Ø Superior holding power and ease of penetration.

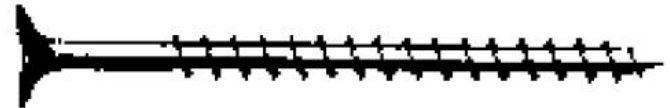

GIB® Grabber™ - Scavenger Head Laminator

For laminating plasterboard to plasterboard



GIB® Grabber™ - High Thread Collated

Scavenger Head Drywall High Thread for fixing GIB® plasterboard to timber.



GIB® Grabber™ Braceline® Screw

- Ø For fixing to timber
- Ø Specifically designed for GIB® BL Bracing systems



GIB® Grabber™ - Self Tapping

Scavenger Head Drywall High Thread for fixing GIB® plasterboard to steel (0.45 – 0.95mm).



GIB® Grabber™ - Self Tapping Collated

Scavenger Head Drywall High Thread for fixing GIB® plasterboard to steel (0.45 – 0.95mm).



GIB® Grabber™ - Wafer Head Self Tapping

A low profile fastener for attaching metal to timber



GIB® Nail

Designed and recommended for fixing GIB® plasterboard



GIB® Braceline nail

For use in GIB® BL Bracing Systems



GIB® Grabber® Special Purpose Screws

A self tapping screw designed for fixing high density GIB-Board® (e.g. GIB Noiseline®) without pouching.



Adhesives & Sealants



GIBFix® One

Plasterboard to wood and metal adhesive

- ü Timber framing
- ü Metal framing
- Ø Suitable for timber and steel substrates including all treated timber
- Ø Water based, solvent free and virtually odour free
- Ø Tested to exceed the requirements of AS2753-1985
- Ø In 375ml cartridges, 600ml sausages and 4L pails
- Ø Ultra Low VOC content



GIBFix® All-Bond

Plasterboard to wood and metal adhesive

- ü Timber framing
- ü Metal framing

- Ø Suitable for timber and steel framing, including all treated timber (treated in accordance with NZ 640:2003)
- Ø Well suited for application in winter conditions
- Ø Strong bond, solvent based
- Ø Available in 375ml cartridge and 600ml sausage

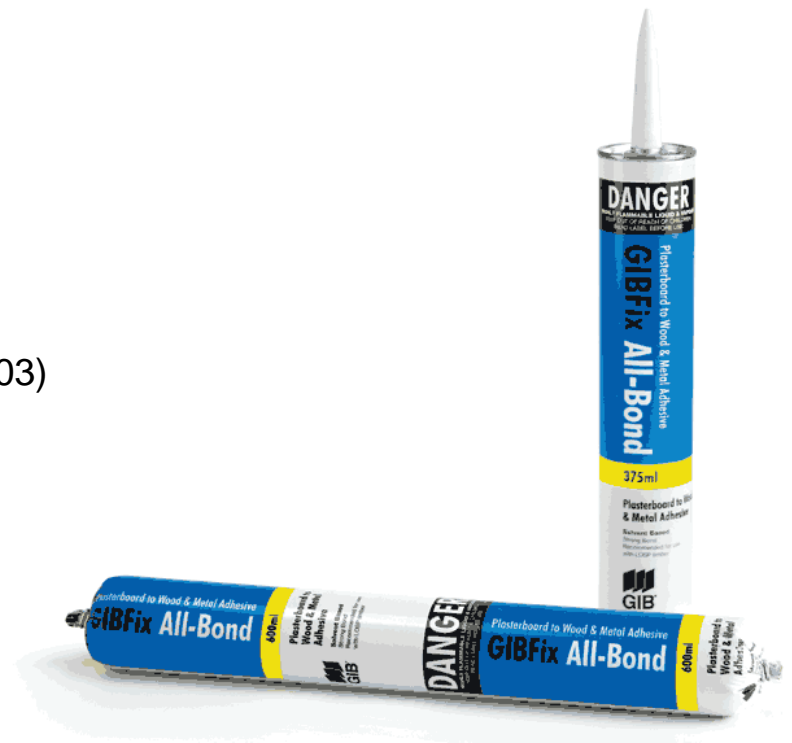

GIB Soundseal®

Highly flexible acoustic sealant

- ü Use in GIB Noise Control® Systems
- ü Paintable and easy to apply
- Ø Reduces sound transmission in partition and framewall systems.
- Ø Water based
- Ø Surface dries to a tough film which remains permanently flexible to form a long lasting resilient seal
- Ø Non-staining and easily painted
- Ø Easy to apply
- Ø In 375ml cartridge and 600ml sausage



How much adhesive to use?

- Ø Reduce waste and have consistently sized daubs of adhesive by removing the sealer cap from a sipper type drink bottle top and fitting it to the nozzle of an adhesive cartridge.
- Ø Press the face of the cap against the surface and apply pressure to the adhesive applicator gun.
- Ø The cap will fill with adhesive and when full, pull the cap away from the surface.
- Ø This will leave a daub of adhesive approximately 35mm in diameter and with a raised “peak” of about 10 – 12mm.
- Ø The larger surface area on the end of the nozzle prevents adhesive “running” after application, thereby reducing waste and mess.

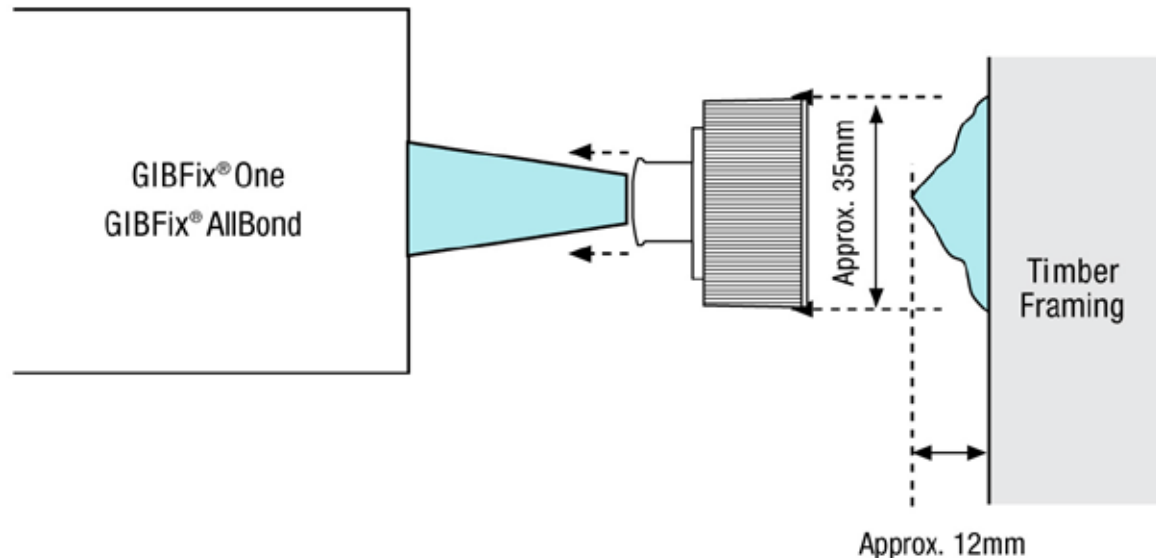

Trims and Beads



Trims and Beads

GIB® Goldline™ Platinum Trims

- Ø Results in clean precise corners that are long lasting.
- Ø Made with a patented, high quality paper laminated to various metal profiles providing strength and protection.
- Ø Simple to install.
- Ø No need for fasteners, so no chance of fastener popping.
- Ø Risk of cracking significantly reduced.
- Ø Trims come in 2.4, 2.7 and 3.0m lengths.

Square Corners

- Ø Create clean lines and precise square corners.
- Ø Available in 90° and 135° outside/inside corners.

Bullnose Corners

Inside and outside trims that create rounded corners.

L-Trims & Reveals

- Ø Used to trim plasterboard where it meets other surfaces.
- Ø Use together to create control joints.

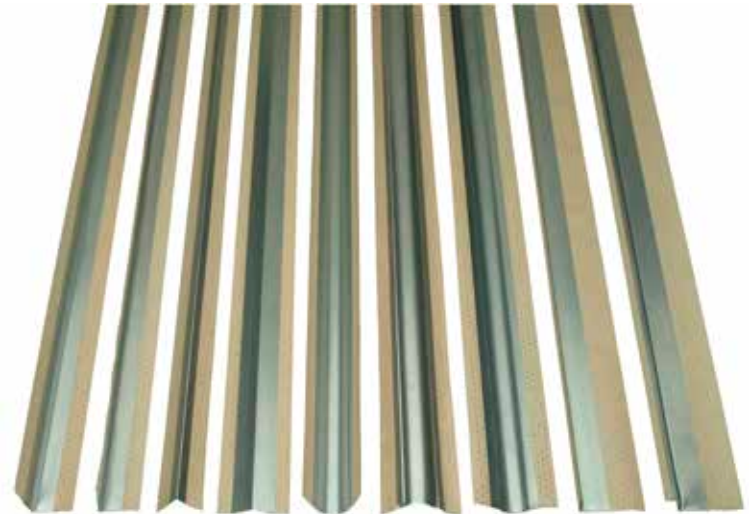

Trims and Beads

GIB® UltraFlex and GIB® UltraFlex Lite

High Impact Corner Mould Internal and External Drywall Corner Finishing System

- Ø Suitable for all off-angles
- Ø Ultra-thin edge for 1-step installation and easy finishing
- Ø Crack resistant
- Ø Available in 30m rolls. Cut to length as required.
- Ø Perforated edges, allow faster drying (GIB® UltraFlex Lite)



GIB® Paper Tape

Reinforces GIB® plasterboard joints and internal corners

- Ø Combine with GIB® compounds
- Ø 75m, 150m lengths



Metal Products



**GIB® Rondo®
Battens and
Accessories**



GIB® Rondo® Battens and Accessories

The GIB® Rondo® metal battens will not bend, twist or warp and therefore maintain a stable, straight and level ceiling once installed.

Furthermore, they are:

- Ø versatile with several fixing options
- Ø safe and easy to handle

- Ø There are several clips to improve acoustic performance
- Ø The systems are lightweight and easy to install using current fixing methods and tools.

GIB® Rondo® Battens and Accessories

GIB® Rondo® 310 ceiling batten system - 35mm deep

Can be direct fixed or installed using clips

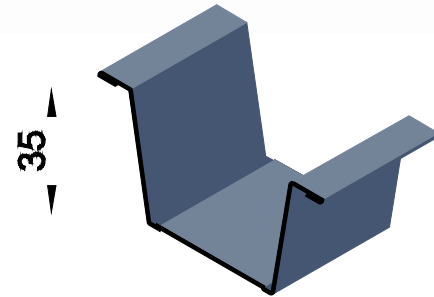

The NZ31 ceiling batten system – 16mm deep

Can be direct fixed or installed using clips

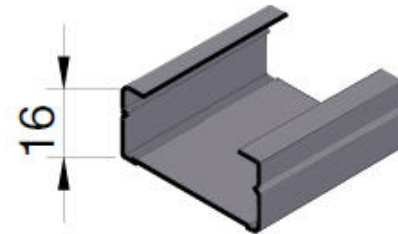

The 308 batten system - 16mm deep PLUS the 129 batten as a 28mm deep option

Can be installed using clips or using a suspend grid system

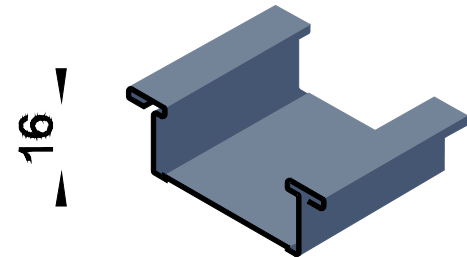

GIB® Rondo® Battens and Accessories

GIB Quiet Clip®

- Ø Reduces noise
- Ø Improves low frequency sound/impact insulation
- Ø No special flooring systems required
- Ø Easy fit installation

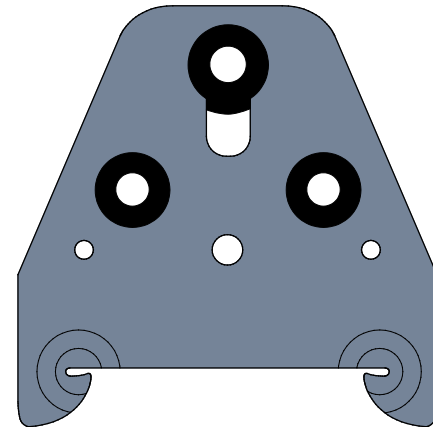

Metal Trims

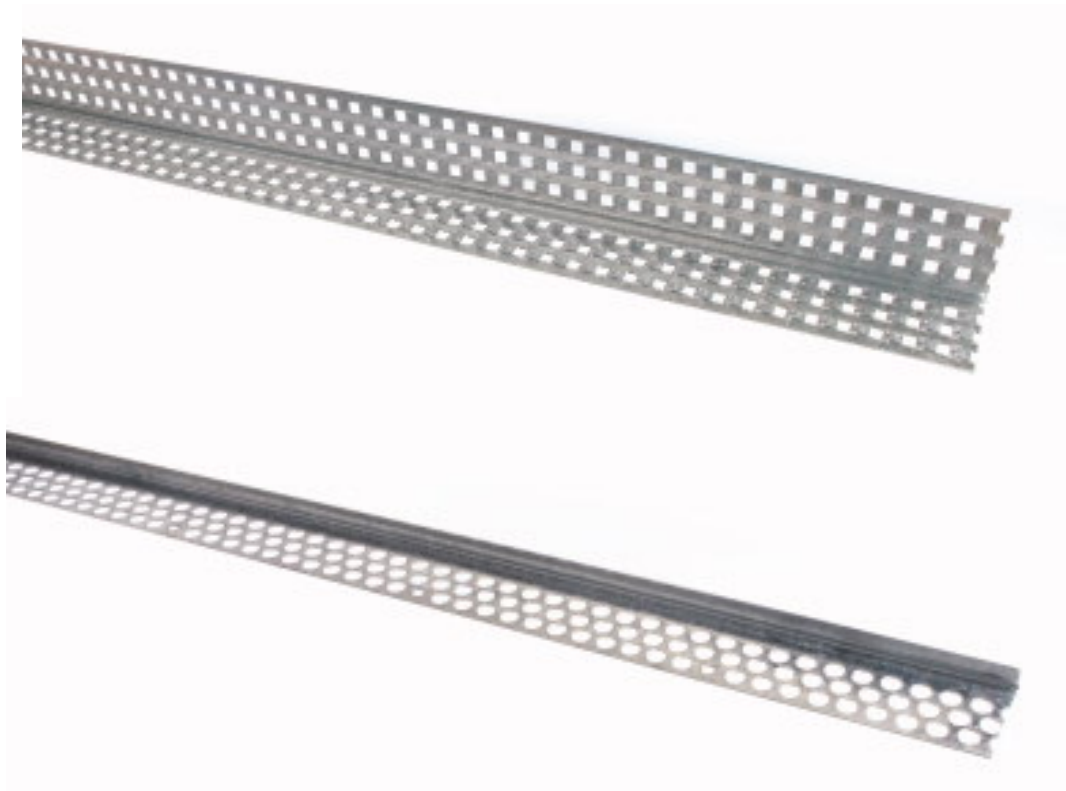

Metal Trims

GIB® Slim Angles and Rondo® Corner Beads

Ø Basic corner reinforcement

Ø 90° by 2.4m, 2.7m and 3.0m

Ø 135° 2.4m

Ø Arch Bead 2.4m



Ext 90° angle



Int 90° angle



Ext 135° angle

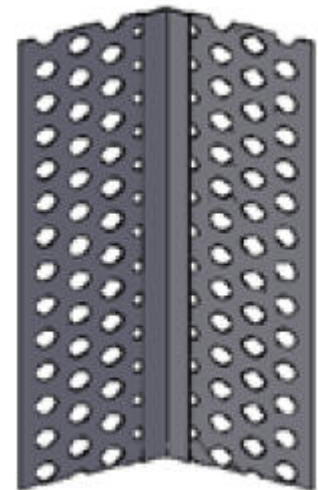

Int 135° angle

Metal Trims

Stopping Angles and Beads

Provides a trim to sheet edges.

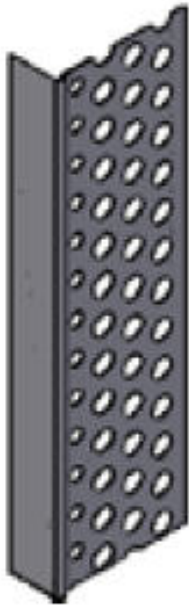

Stopping angle



Stopping bead

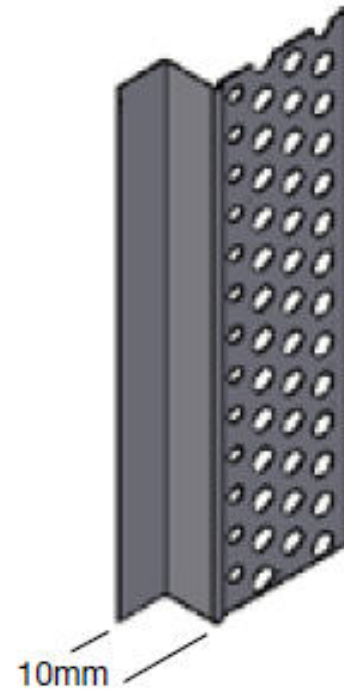

ShadowLine stopping angle

Metal Trims

Arch Beads

For use in curved applications such as arches

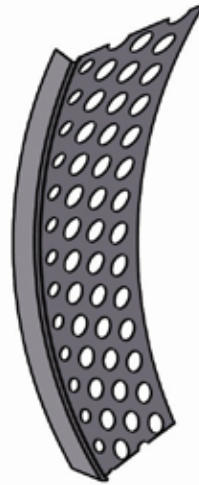

Control Joints

Required to reduce the impact of cracking.

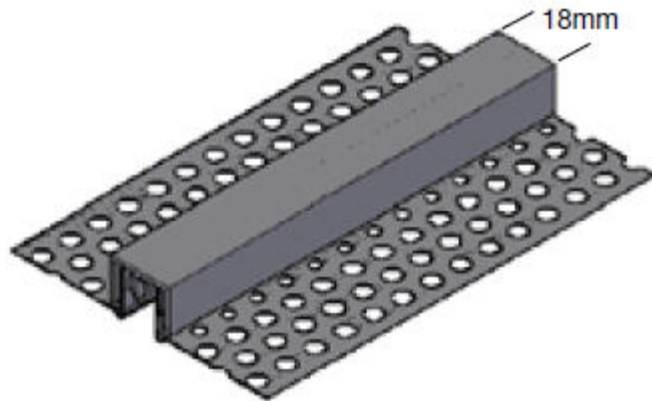

Casing Beads

Provides a trim to sheet edges.



Other Metal Trims

GIB® Rail – Resilient Channel

Provides semi-structural sound isolation of linings from framing.

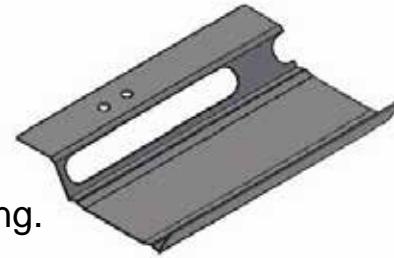

Beam clip to line structural steel members

Provides plasterboard fixing to structural steel framing in conjunction with 140 Perimeter channel

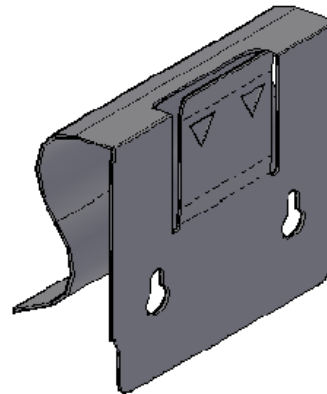

GIB HandiBrac® Bracing Bracket

Panel hold-down bracket for use in GIB® BL and UP bracing systems

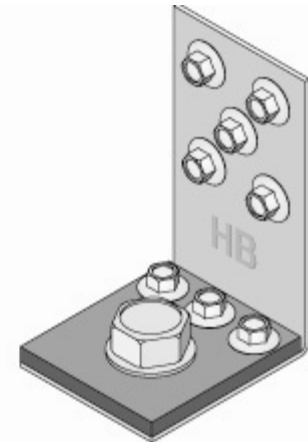

Best Practice Installation



13mm GIB® plasterboard at 600mm centres

A better ceiling finish with 13mm GIB® plasterboard.

- Ø Thicker 13mm plasterboard is easily installed at 600mm.
- Ø Use less battens, screws and glue compared to fixing battens at 450mm centres.
- Ø Save up to 3 hours labour on the average job.
- Ø Fewer contact points, fewer potential fastener problems and fewer chances of call backs simply by increasing the batten spacing to 600mm centres.
- Ø Helps to achieve a superior, flatter finish.



Straighter ceilings with GIB® Rondo® Metal Ceiling Battens.

- Ø GIB® Rondo® Metal Ceiling Battens hold no moisture so they will not bend, twist or warp.
- Ø Minimises the chance of cracking, popping and peaking.
- Ø Less movement and fewer problems.



GIB® Rondo® Ceiling Batten System

Refer to pg 45 of the GIB® Site Guide January 2010 issue for installation instructions

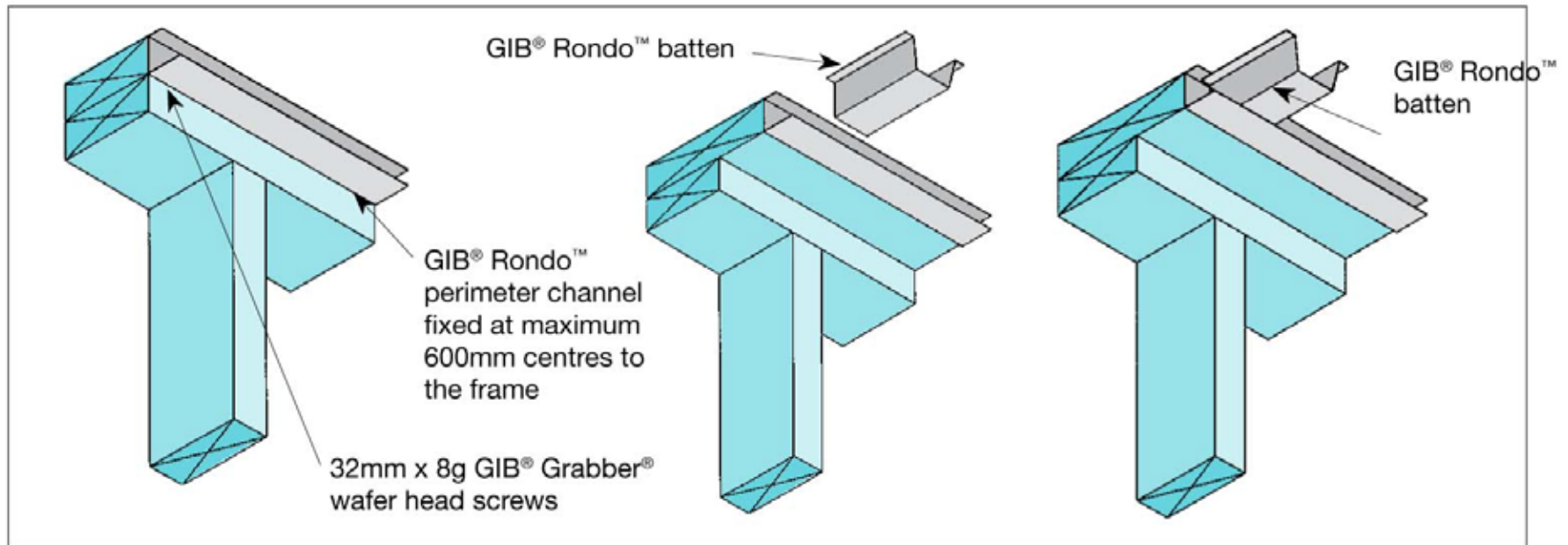

GIB® Paper Tape vs Fibre Tape

Only GIB® Paper Tape is to be used for jointing systems

- Ø GIB® Paper jointing tape offers superior crack resistance and is the only jointing tape recommended by Winstone.
- Ø The paper tape absorbs compound to form a solid joint.
- Ø Non absorbent fibreglass jointing tape is unable to do this.
- Ø Paper tape comes pre-creased and has two distinct sides.
- Ø The rougher side, facing out of the roll, is always bedded face down into the compound.

Note: Fibre mesh tape is not permitted in Winstone Wallboards installation recommendations.

Fibre mesh tape is far less resistant to any substrate movement that can ultimately lead to joint cracking.



Recommended fixing method for screws and glues

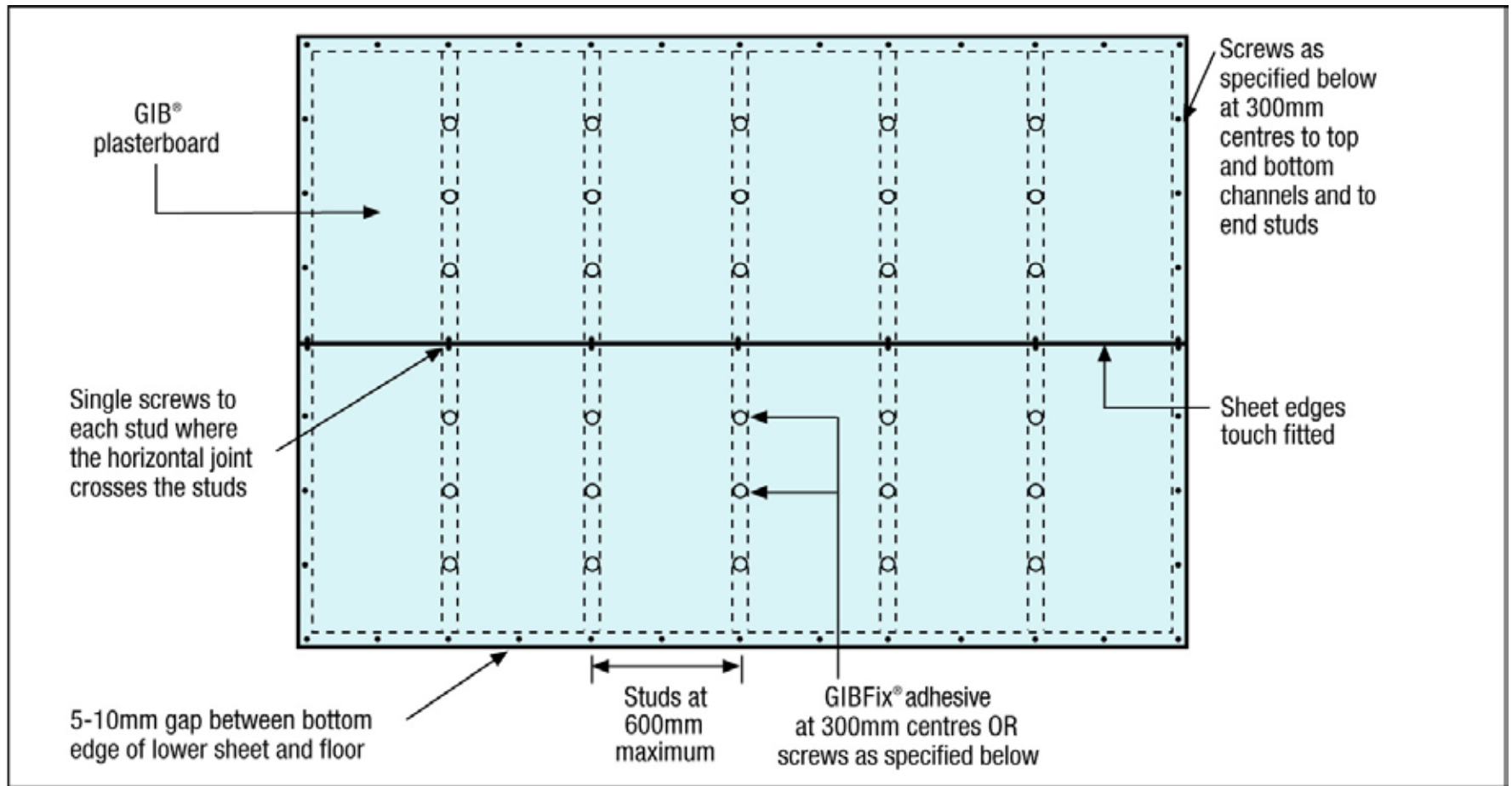

BRANZ Appraisals



BRANZ Appraised

BRANZ Appraisals

A BRANZ Appraisal represents regular and ongoing assessment of key performance elements such as fitness for purpose, compliances with the NZ Building Code and ongoing manufacturing quality assurance.

The following are the current BRANZ Appraisal Certificates for GIB[®] products or systems

GIB [®] Product or System	BRANZ Appraisal Certificate
GIB [®] Fire Rated Systems	289 (2006)
GIB [®] EzyBrace [™] Systems	294 (2009)
GIB Ultraline [®] PLUS Lining System	324 (2006)
GIB Noise Control [®] Systems	394 (2006)
GIB Aqualine [®] Wet Area Systems	427 (2007)

Winstone Wallboards Ltd is the only plasterboard supplier with **five BRANZ Appraisal certificates.**

BRANZ Appraisals



GIB Aqualine® Wet Area Systems have been appraised for use as a wet area wall and ceiling lining in buildings:

1. On framed walls and ceilings within the scope limitations of NZS 3604, and
2. On timber and light gauge steel framed walls subject to specific design

[BRANZ Appraisal Certificate 427 \(2007\)](#)



GIB Aqualine® Wet Area Systems



GIB Noise Control® Systems have been appraised for use as Sound Transmission Class (STC) rated for walls and floor/ceilings and Impact Insulation Class (IIC) for floor/ceiling construction elements in buildings. They have also been appraised for environmental noise reduction.

[BRANZ Appraisal Certificate 394 \(2006\)](#)



GIB Noise Control® Systems

BRANZ Appraisals

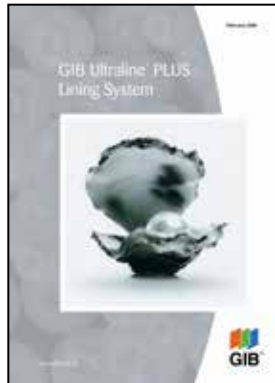

GIB Ultraline® PLUS Lining System has been appraised for use as general, bracing-rated, fire-rated and sound transmission rated interior wall and ceiling lining system in buildings under the following scope:

1. On framed walls and ceilings within the scope limitations of NZS 3604, and
2. On timber and light gauge steel framed walls subject to specific design

[BRANZ Appraisal Certificate 324 \(2006\)](#)

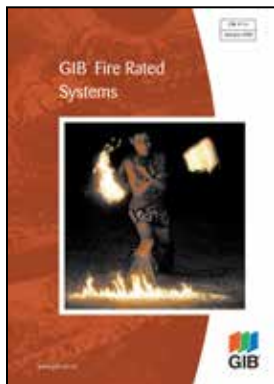

GIB® Fire Rated Systems have been appraised for use as fire-rated load bearing and non-load bearing framed construction elements in buildings.

[BRANZ Appraisal Certificate 289 \(2006\)](#)



GIB Ultraline® PLUS Lining Systems



GIB® Fire Rated Systems

Technical Literature

Winstone Wallboards offers an extensive range of tested systems to ensure compliance with the requirements of the NZ Building Code. Detailed and appraised information about these systems can be found in the literature below, in order of:

[GIB Ultraline® PLUS Lining Systems](#)

[GIB Noise Control® Systems](#)

[GIB® Fire Rated Systems](#)

[GIB® Site Guide](#)

[GIB Aqualine® Wet Area Systems](#)

[GIB® EzyBrace™ Systems](#)

[GIB X-Block® Radiation Shielding Systems](#)

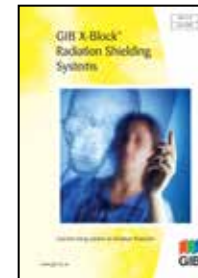
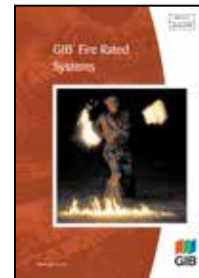
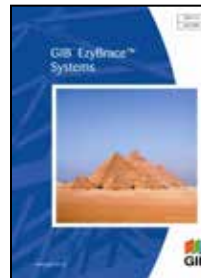

Sustainability Accreditations



Environmental Choice

- Ø New Zealand's only manufactured plasterboard with Environmental Choice certification for all GIB® plasterboard 13mm or greater in thickness
- Ø Made from 100% recycled paper and naturally occurring gypsum
- Ø Does not contain toxins



How is Winstone Wallboards minimising our impact on the environment?

- Ø Reducing greenhouse emissions by 20% over the past 15 years
- Ø Our cut-to-length service reduces on-site waste of GIB® plasterboard
- Ø Diverting all manufacturing waste GIB® plasterboard away from landfill and into compost
- Ø And more!

Visit www.gib.co.nz/enivonmentalchoice for more information or call 0800 100 442 for a copy of our "Creating Greener Environments" brochure



Online Consumer Resource



GIB Living®

GIB Living® is the perfect blend of practical advice and design inspiration to help your customer get the home they really want, with some fantastic interactive tools and resources.

GIB Living

Search Go

Room by Room Design & Planning Products Tools & Resources

Building your new home?...
Get the home you really want with GIB Living®

Interactive Guide
Use our Room by Room Guide to help you get the home you really want. [move >](#)

Feature Selector
Using our online tool choose from a variety of feature options to transform your home. [move >](#)

DIY Video
Don't waste time stripping and sanding, for that great finish watch how to remove and reline. [move >](#)

Competition
Let us pay for your project! Win \$8,000 worth of home improvement vouchers. [move >](#)



Interactive Room by Room Guide

What you need to consider and the solutions available



Features Design Tool

See the difference your choices make to the look of a room

GIB Living®



Visit www.gibliving.co.nz today and find out how you can use this resource to your benefit.